

Replacement Parts

Current : 40-125 Amps
Duty Cycle: 125 Amps at 60%
Gas: Air/N2
Gas Pressure
 - Cutting: 72-87 PSI (5.0-6.0 bar)
 - Gouging: 58-65 PSI (4.0-4.5 bar)
Gas Flow at 125A: 630 SCFH (295 lpm)
Pilot : Electrode to Tip (15-18A)
Ignition: Without HF

For the correct operation please use:
 3-Ways Solenoid Valve, inside orifice
 4.5-5.5mm - (0.178-0.217 inches)

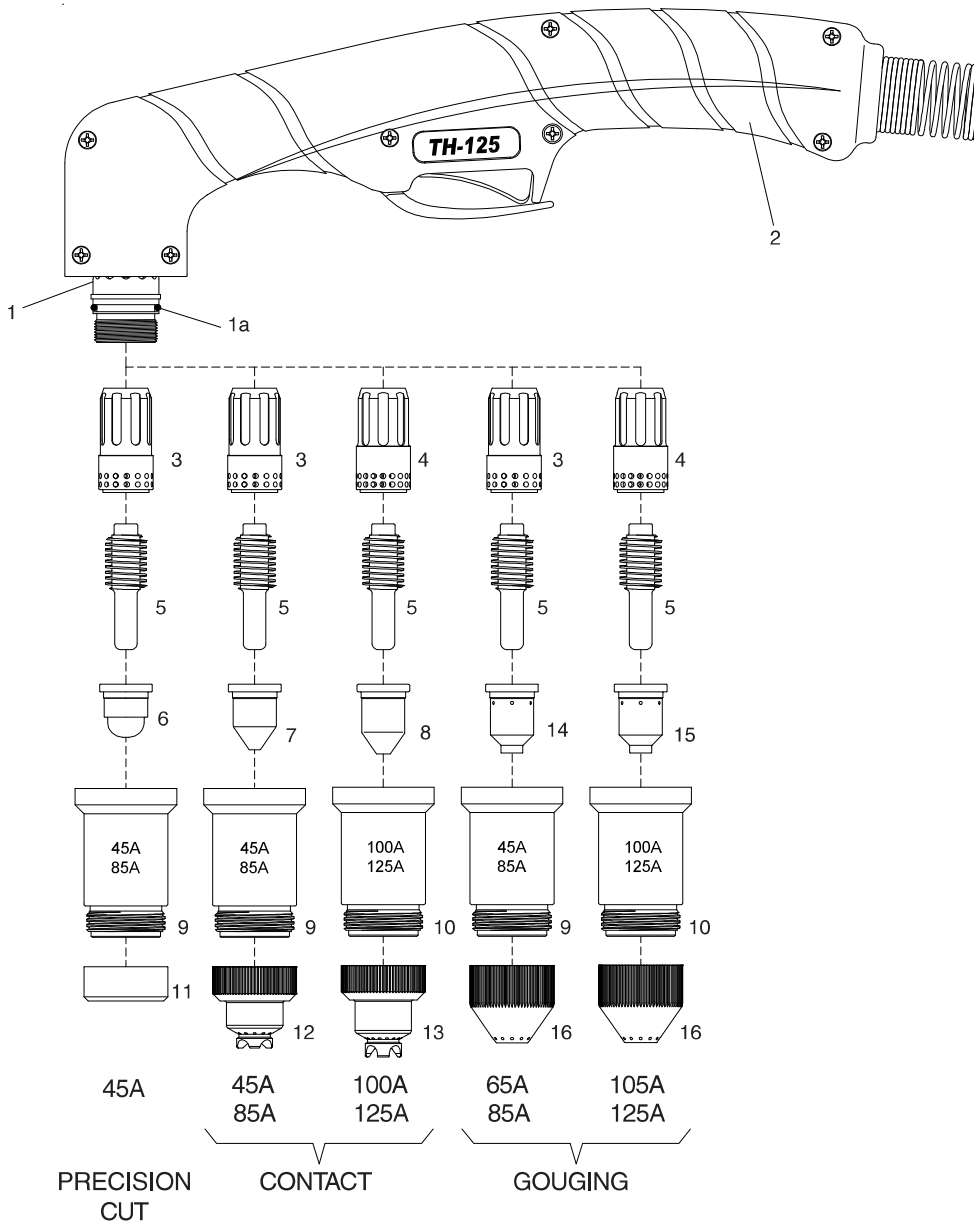

Replacement Parts

Air Filter
AT-1000



Standard
Connection
Euro Connector

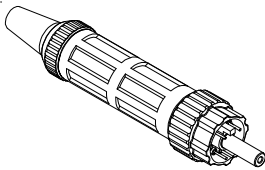

EASYFIT
Connection

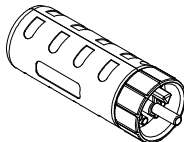

Bevel Tool
Patent pending

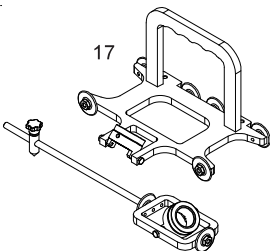

Torch parts

Item	Description	Code
1	● TH-125 Hand Torch Head	03700
1a	● O-Ring	03700.60
2	● Handle with parts	03705
3	Swirl ring, 45-85A	60042E
	Swirl ring, 45-85A Maximum Life	60042
4	Swirl ring, 100-125A	60040E
	● Swirl ring, 100-125A Maximum Life	60040
5	● Electrode, 45-125A	52677
	Electrode, 45-125A, BiMetal	52677BM
6	Tip, Cutting, 45A Precision Cut	51415
7	Tip, Cutting, 45A	51416
	Tip, Cutting, 65A	51417
	Tip, Cutting, 85A	51418
8	Tip, Cutting, 105A	51419
	● Tip, Cutting, 125A	51419.16
9	Shield Cup Body, 45-85A	60309TA
10	● Shield Cup Body, 100-125A	60309TC
11	Deflector, 45A Precision Cut	51928
12	Shield Cap, Hand, 45-85A	51921
13	● Shield Cap, Hand, 100-125A	51926
14	Tip, Gouging, 65-85A	51417G
15	Tip, Gouging, 105A	51418G
	Tip, Gouging, 125A	51419G
16	Shield Cap, Gouging	51927G

Torches and Leads

TH-125	Hand Torch, 6m (20 ft) Leads, Coaxial Cable	03721CX
TH-125	Hand Torch, 12m (40 ft) Leads, Coaxial Cable	03726CX
TH-125	Lead Assembly, Hand, 6m (20 ft) Length, Coaxial Cable	03781CX
TH-125	Lead Assembly, Hand, 12m (40 ft) Length, Coaxial Cable	03786CX

Accessories

N/S	Circle Cutting Attachment	51865
17	BEVEL TOOL	51880

Torches with different connectors available on request.

Replacement Parts

Current : 20-70 Amps
Duty Cycle: 70 Amps 50%
Gas: Air/N2
Gas Pressure
 - Cutting: 72-80 PSI (5.0-5.5 bar)
 - Gouging: 58-65 PSI (4.0-4.5 bar)
Gas Flow at 70A: 390 scfh (185 lpm)
Pilot : Electrode to Tip
Ignition: Without HF

For the correct operation please use:
 3-Ways Solenoid Valve, inside orifice
 4.5-5.5mm - (0.178-0.217 inches)

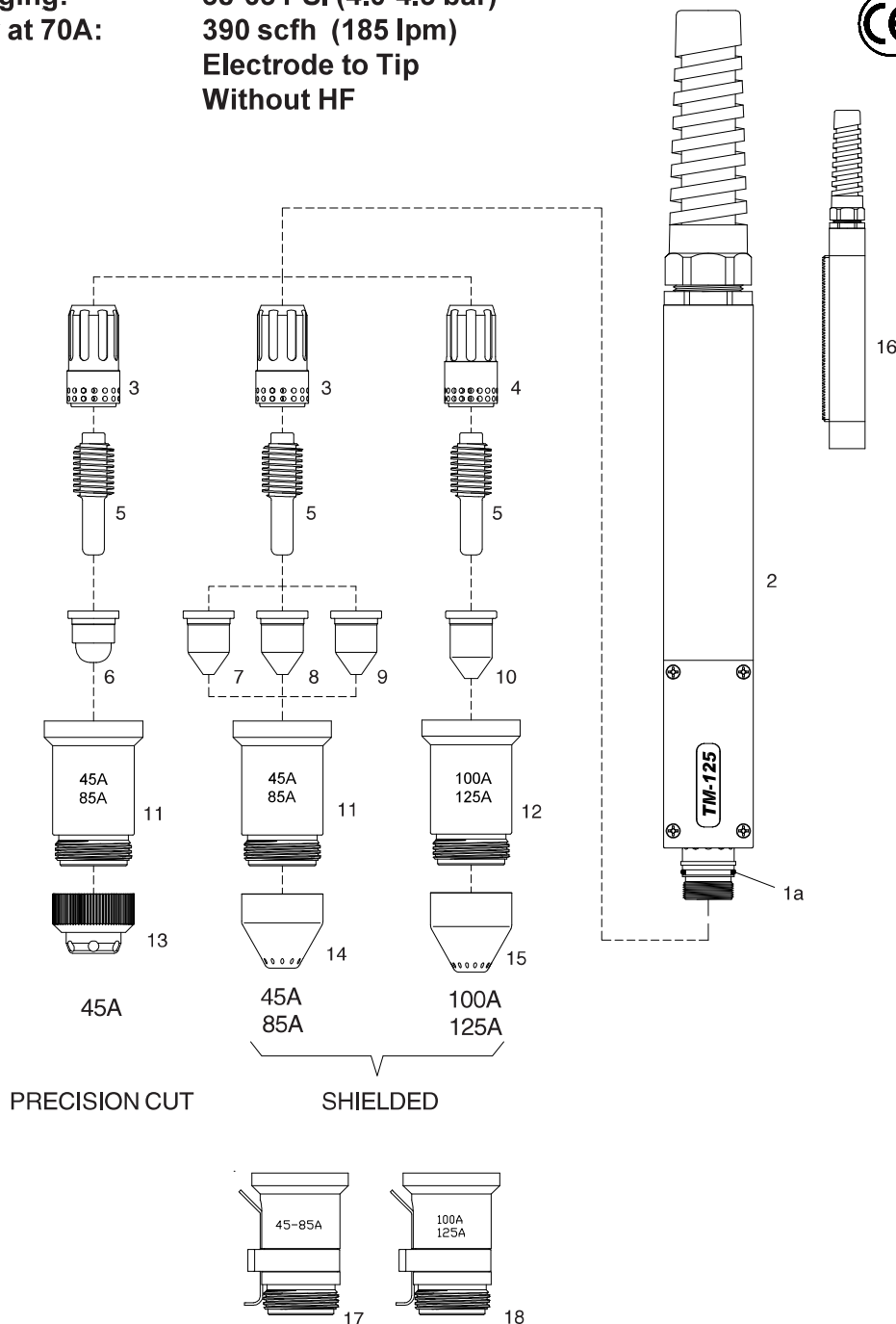

Replacement Parts

Torch parts

Item	Description	Code
1	● TM-125 Machine Torch Head	03710
1a	● O-Ring	03700.60
2	● Fiberglass Positioning Tube	07218
3	Swirl ring, 45-85A	60042E
	Swirl ring, 45-85A Maximum Life	60042
4	Swirl ring, 100-125A	60040E
	● Swirl ring, 100-125A Maximum Life	60040
5	● Electrode, 45-125A	52677
	Electrode, 45-125A, BiMetal	52677BM
6	Tip, Cutting, 45A Precision Cut	51415
7	Tip, Cutting, 45A	51416
8	Tip, Cutting, 65A	51417
9	Tip, Cutting, 85A	51418
10	Tip, Cutting, 105A	51419
	● Tip, Cutting, 125A	51419.16
11	Shield Cup Body, 45-85A	60309TA
12	● Shield Cup Body, 100-125A	60309TC
13	Shield Cap, 45A Precision Cut	51929
14	Shield Cap, Machine, 45-85A	51922
15	● Shield Cap, Machine, 100-125A	51927

Air Filter
AT-1000



Standard
Connection
Euro Connector

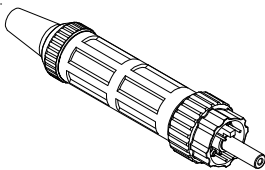

EASYFIT
Connection

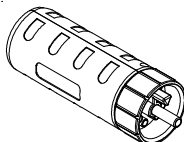

Torches and Leads

TM-125 Machine Torch, 6m (20 ft) Leads, Coaxial Cable	03731CX
TM-125 Machine Torch, 12m (40 ft) Leads, Coaxial Cable	03736CX
TM-125 Lead Assembly, Machine, 6m (20 ft) Length, Coaxial Cable	03791CX
TM-125 Lead Assembly, Machine, 12m (40 ft) Length, Coaxial Cable	03796CX

Accessories

16	Fiberglass Positioning Tube With Rack	07219
17	Shield Cup Body, 45-85A OHMIC	60309THA
18	Shield Cup Body, 100-125A OHMIC	60309THC

Torches with different connectors available on request.